

N° 81 - PIANO RIALZATO

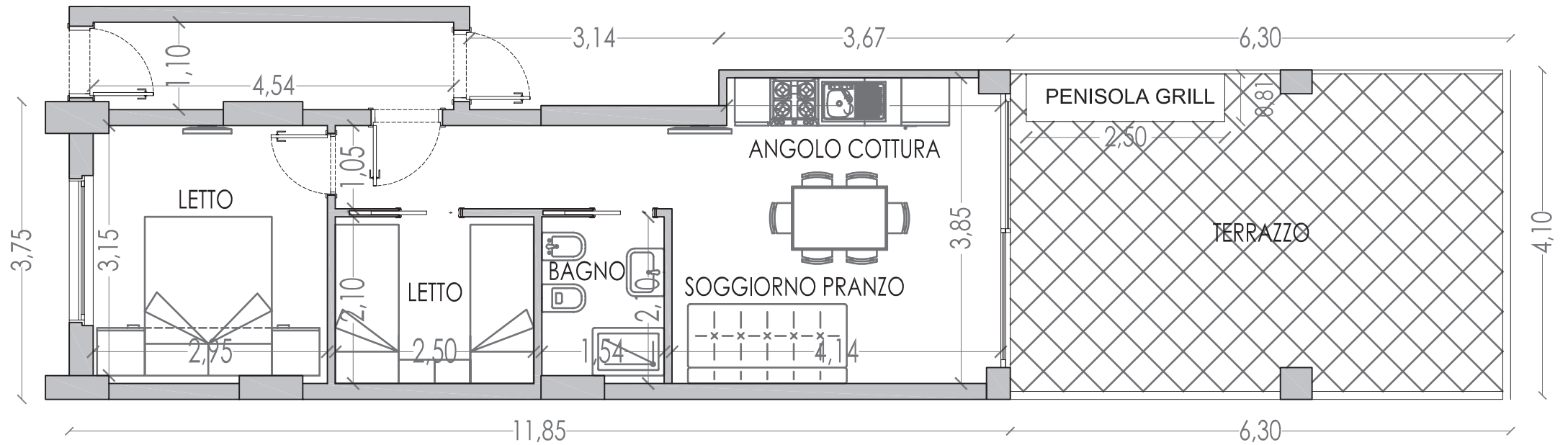

SUPERFICIE LORDA =	45.99 mq
SUPERFICIE TERRAZZO (50%) =	12.92 mq
SUPERFICIE CONDOMINIALE [(LORDA + TERRAZZO) 8%] =	4.71 mq
SUP. TOTALE =	<u>63.62 mq</u>