

N° 80 - PIANO RIALZATO

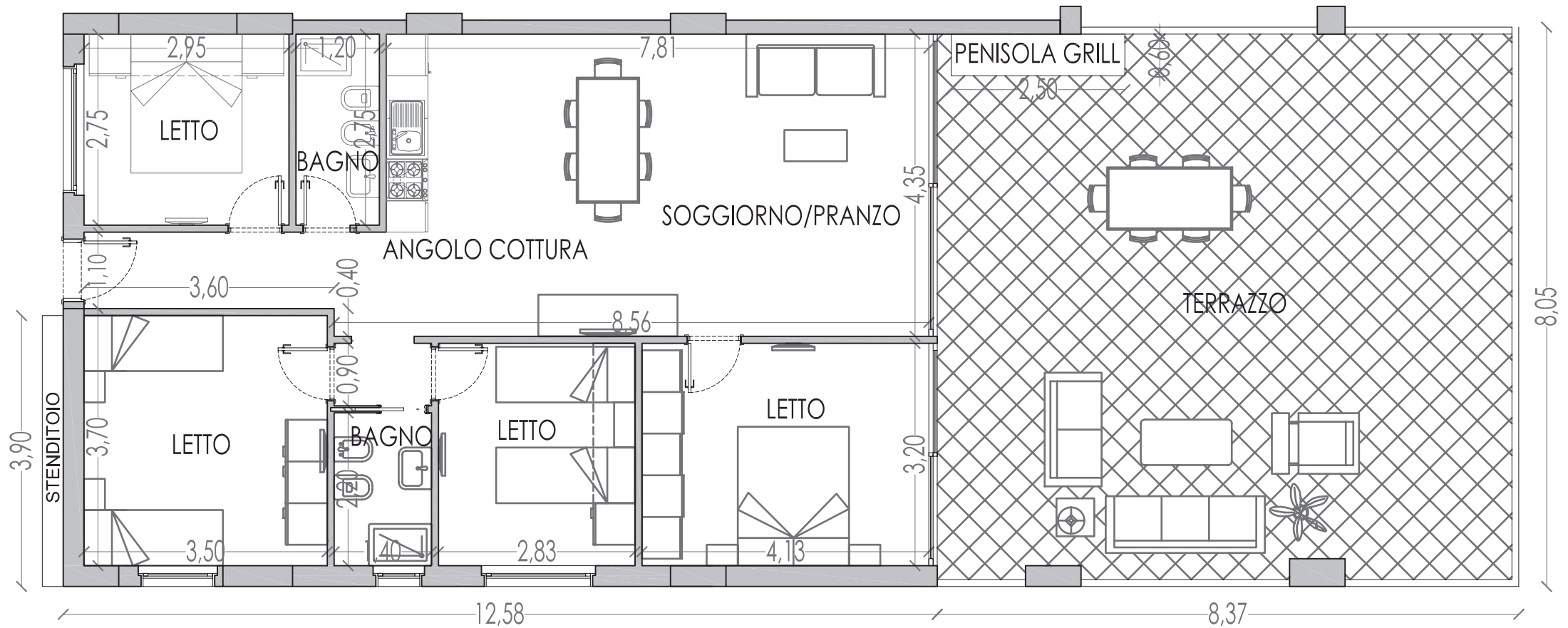

SUPERFICIE LORDA =	102.53 mq
SUPERFICIE TERRAZZO (50%) =	33.69 mq
SUPERFICIE CONDOMINIALE [(LORDA + TERRAZZO) 8%] =	10.90 mq
SUP. TOTALE =	147.12 mq